

FX2 RECESSED STEEL TRIMLESS SUBMITTAL : DIMENSIONS

DOOR SERIES #	Tub I.D.			Frame O.D.		Wall Opening		
	A	B	C	E	F	W	H	D
6014	24	30	6	27 1/8	33 1/8	25	31	6 11/16
6114	24	30	8	27 1/8	33 1/8	25	31	8 11/16
6214	24	34 3/4	6	27 1/8	37 7/8	25	35 3/4	6 11/16
6414	24	34 3/4	8	27 1/8	37 7/8	25	35 3/4	8 11/16
6614	24	38 3/4	8	27 1/8	41 7/8	25	39 3/4	8 11/16
6314	30	30	8	33 1/8	33 1/8	31	31	8 11/16
6514	32 3/4	34 3/4	8	35 7/8	37 7/8	33 3/4	35 3/4	8 11/16
7214	32 3/4	38 3/4	8	35 7/8	41 7/8	33 3/4	39 3/4	8 11/16

Top View

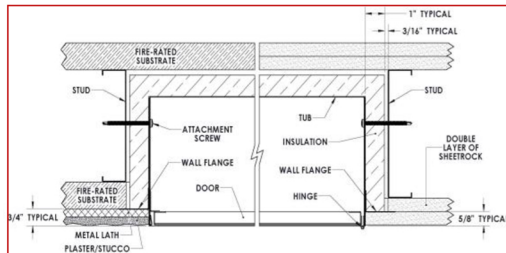
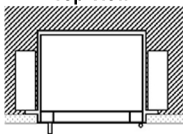

3/4" PLASTER

5/8" DRYWALL

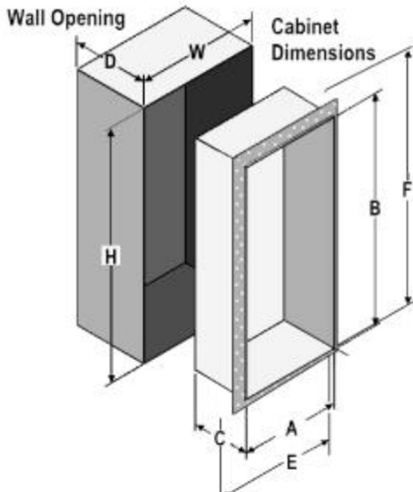

Trimless K.O.s centered only—no offset